



Address 71 Wolf Dr, Bragg Creek, AB
Date May 15, 2023
Name Kathleen Burk | Re/Max Realty Professionals
Email kathleenburk@remax.net
Phone 403.818.8049

FLOOR TOTALS

Main Lower	196.60 sqft / 18.26 m2	Total Size	2332.56 sqft / 226.91 m2
Main Level	1394.23 sqft / 129.52 m2	Total w/basement	4003.77 sqft / 371.95 m2
Upper Level	851.79 sqft / 79.13 m2	Order Procedure	RECA RMS
Basement Total	1561.26 sqft / 145.04 m2	Exterior Wall Size	2 X 6
*Developed Area	1194.84 sqft / 111.00 m2	Order Type	Detached Single Family



ROOM DIMENSIONS

Kitchen	12'5" X 10'9" ft/in	M	Laundry	5'0" X 4'11" ft/in	M
Dining Area	15'7" X 11'3" ft/in	M	Mud Area	5'11" X 3'7" ft/in	M
Kitchen Nook	9'0" X 5'8" ft/in	M	Hot Tub Room	14'9" X 10'3" ft/in	B
Living Room	18'0" X 17'8" ft/in	M	Deck	24'5" X 8'11" ft/in	M
Family Room	14'11" X 11'2" ft/in	M	Porch	6'11" X 3'10" ft/in	M
Foyer	8'11" X 6'6" ft/in	M	Garage	30'8" X 20'5" ft/in	M
Bonus Room	19'3" X 18'3" ft/in	B	Rec Room	29'11" X 12'7" ft/in	B



BEDROOM DIMENSIONS & ADDITIONAL

Primary	15'8" X 13'5" ft/in	U
Bedroom Two	14'9" X 10'5" ft/in	U
Bedroom Three	11'0" X 11'10" ft/in	U

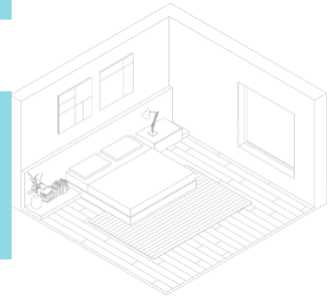

BATHROOM PIECES

Two Piece	5'5" X 4'10" ft/in	M
Three Piece	10'6" X 4'11" ft/in	B
Five Piece	8'11" X 7'9" ft/in	U
Three Piece <i>Ensuite</i>	8'11" X 5'5" ft/in	U

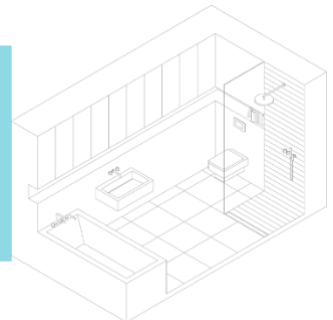

*Insured measurements are based on local guidelines.